



Description

Introducing the T8 LED tube, a top-of-the-line lighting solution that combines energy efficiency with exceptional brightness and durability. With a range of wattage options available, from 9 watts up to 18 watts, this LED tube is designed to provide reliable, long-lasting illumination for a wide range of applications. One of the standout features of the T8 LED tube is its sturdy aluminum housing, which ensures maximum durability and longevity. The tube also features a high-quality polycarbonate lens, which can be ordered in either clear or frosted finishes, depending on your specific lighting needs. But what really sets this LED tube apart is its energy efficiency, with its low wattage and high lumen output helping to reduce your energy bills and your carbon footprint. With its long lifespan and low maintenance requirements, the T8 LED tube is a cost-effective lighting solution that delivers reliable performance over the long term.

Applications

Warehouses
 Offices
 Retail Spaces
 Hospitals and Healthcare

Photometry

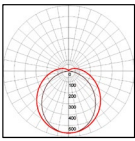

140°

Mounting Options

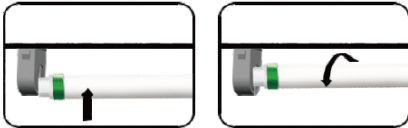

Single End & Double End Options

Dimensions

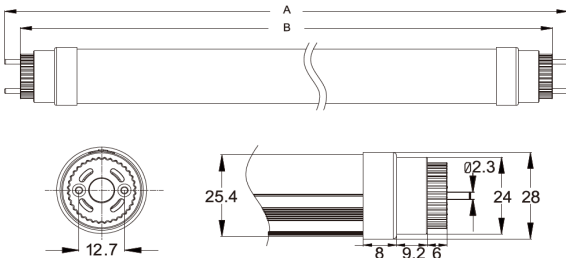

	2ft	4ft
A	23.7"	47.7"
B	23.14"	45.1"

The dimensions in the image are in mm

Electrical Information

Model No.	TB9-T82	TB10-T84	TB12-T84	TB15-T84	TB18-T84
Power Consumption(±10%)	9W	10W	12W	15W	18W
Power Supply	LED Driver				
Input Voltage	AC 100-277 VAC 50/60 Hz				
Power Factor	>0.9				
THD	<20%				
Control	Not Dimmable				

Optic Information

LED Type	SMD 28335				
Luminous Flux (±10% 160 lms/w)	1140 lms	1600 lms	1920 lms	2400 lms	2880 lms
Efficacy Options (4000K Ra80)	S-190 lms/w, T-160 lms/w, H-130 lms/w				
Correlated Color Temperature	2700K, 3000K, 3100K, 4000K, 4500K, 5000K, 6000K, 6500K				
Color Rendering Index	Ra80				
Beam Angle	140°				
UGR level	N/A				

Dimensions and Mount

Product Dimension (L)	23.7"	47.7"
Carton Gross Weight (25 units)	12.7 lbs	25 lbs.0
Carton Size (25 units) (LxWxH)	24x7.4x4.7	48.2x7.4x4.7
Mounting	Single End & Double End Options	
Socket Type	G5 bi-pin socket (shunted and non-shunted)	
Material	Aluminum	
Fixture Color	Polycarbonate Lens	
IK Rating	Clear or Frosted Lens Available	
IP Rating	N/A	
	IP20	

Lifespan and Warranty

Operating Temperature	-40°F to 104°F
Warranty	5 Years

Safety Certifications

Luminaires (UL 1598:2021 Ed.5)
 Luminaires (CSA C22.2#250.0:2021 Ed.5)