



Electrical Information			
Model No.	IC7-200	IC7-400	IC7-600
Power Consumption (±3%)	200W (±5%)	400W	600W
Power Supply	INVENTRONICS/SOSEN		
Input Voltage	100-277 VAC / 277-480VAC (SOSEN DRIVER ONLY), 50 / 60 Hz		
Power Factor	>0.92		
Surge Protection	6kV line-line, 10kV line-earth		
Driver Type	Constant Current (CC)		
Control	1-10V dimmable, DMX control		
Optic Information			
LED Type 1	LED 5050 (for 30°, 45°, 60°)		
Luminous Flux (±10%)	28,000 lm	56,000 lm	84,000 lm
Efficacy (5000K Ra70)	140 LM/W		
Beam Angle	F06003, F06005, F06006,		
LED Type 2	LED 3737 (for 10°, 15°, 15x40°)		
Luminous Flux (±10%)	25000 lm	50000 lm	75000 lm
Efficacy (5000K Ra70)	125 LM/W		
Beam Angle	F06001, F06002, F06004		
Correlated Color Temperature	4000K, 5000K		
Color Rendering Index	Ra70 (Ra80 optional)		
UGR level	N/A		

## Description

Full series available by 200W to 1200W, ideal to retrofit the 400W to 3000W traditional lamps. The compact modular design allows for a quick assembly and flexible installation. Easily adjustable light angle to create diversity of lighting for various environments. IC7 is the most valuable and reliable high power floodlight in the market. Widely applicable to sports fields, plazas, docking spaces, etc.

## Key Features

- Modular design from 200W to 600W
- Vertical angle for easily light angle adjustment
- Multiple optics option from 10° to 15° to 30° for excellent light pollution control
- Electrophoresis and powder coating with strong anti-corrosion
- Efficiency up to 140lm/W for more energy saving
- Provided with 10KV/20KV built-in surge protection devices

## Applications

- Exhibition centers
- Parking lots
- Outdoor sports fields
- Stadiums
- Recreational sports fields (e.g., soccer fields, tennis courts, basketball courts, etc.)

*\*Lumen output and light distribution are only for reference. Not all product variations listed on this page are DLC Standard/Premium qualified. Visit [www.designlights.org/search](http://www.designlights.org/search) to confirm qualification.*

## Dimensions and Mount

Product Dimension	12.63"×12.44"×4.65"	16.49"×13.38"×8.74"	20.82"×13.38"×8.89"
Luminaire Net Weight	9.02±0.66 lbs.	20.68±0.66 lbs.	33.66±0.66 lbs.
Export Carton Size	14.17"×6.29"×14.76"	18.81"×10.62"×15.35"	23.54"×11.02"×15.74"
Gross Weight	10.34±0.66 lbs.	23.32±0.66 lbs.	36.96±0.66 lbs.
Mounting Option	Bracket Mounting		
Material	Aluminum Alloy		
Finish	Powder Coating		
Fixture Color	Silver		
EPA	0.6ft²	1.34ft²	1.96ft²
IK Rating	IK08		
IP Rating	IP66		

## Lifespan and Warranty

Operating Temperature	-22°F to 122°F
Life Time of LED @Ta=25°C	53,000 hrs - L90
	111,000 hrs - L80
	176,000 hrs - L70
Warranty	5 Years

## SAFETY CERTIFICATIONS

Luminaires (UL 1598:20221 Ed.5)  
Luminaires (CSA C22.2#250.0:2021 Ed.5)

## Photometry

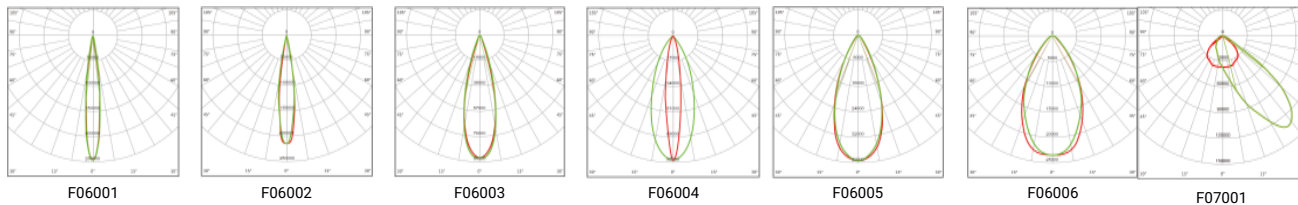

## Mounting Options

### Bracket mounting



## Dimensions

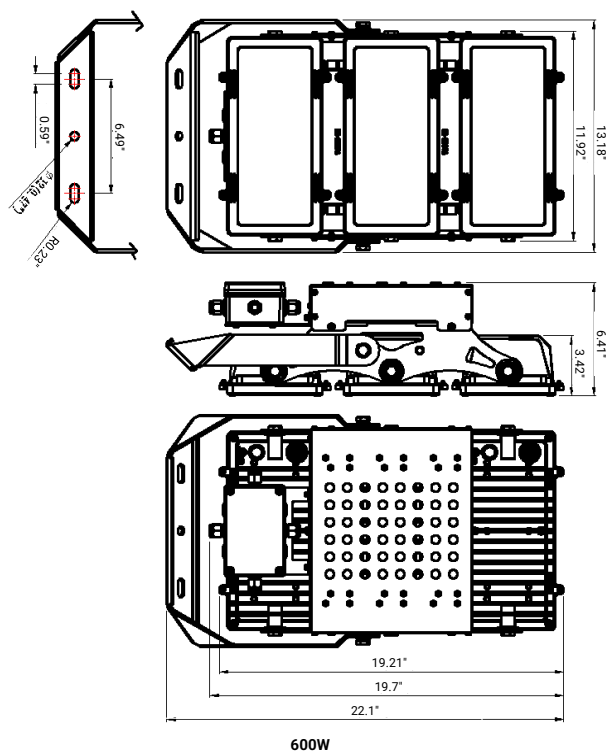
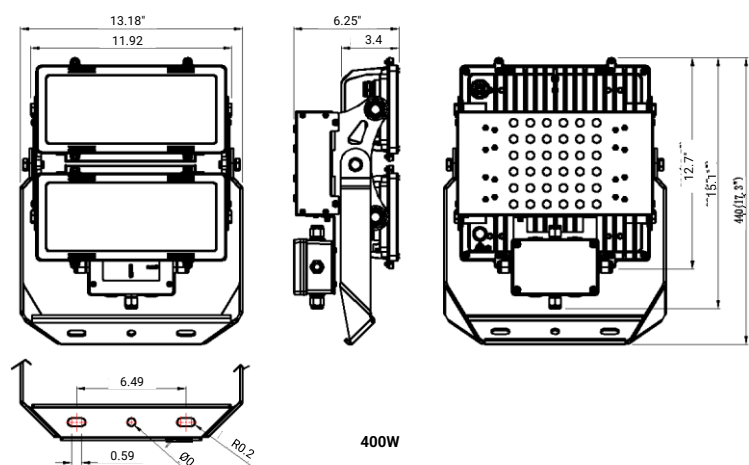
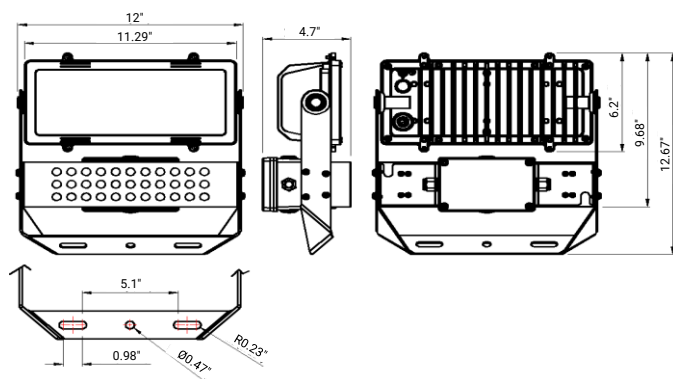

## Accessories

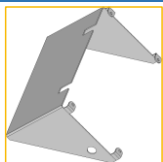

### Shield

SPCC materials for single LED module.

Code: BC-F13-04



### Safety rope

Auxiliary safety device to prevent accidents.



### Adaptor mounting